

#5705

METALLIZED POLYPROPYLENE CAPACITORS

PPM 200-168 df J

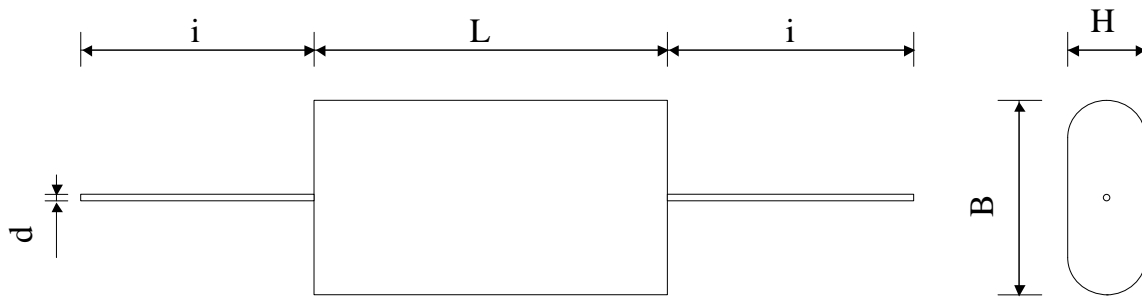

Dielectric of metallized polypropylene

Polyester wrapped

Epoxy resin sealing

Parameter	Symbol		Value	Unit	Condition
Capacitance	C		0.068	μF	1 V / 1 kHz
Tolerance			± 5	%	
Rated voltage	$U_n \text{ DC}$		2000	VDC	
Rated voltage	$U_n \text{ AC}$		500	V_{eff}	50 Hz
RMS Current Max.	I_{eff}		0.6	A_{eff}	3 kHz
slope of voltage variation	$du/dt \text{ max.}$		3'50t	V/ μsec	max. repetitive
Repetitive surge current	$I \text{ cr. max}$		238	A	
Tangent delta	$\text{tg}\delta$		4	10^{-4}	1 V / 1 kHz
Tangent delta	$\text{tg}d$		4	10^{-4}	1 V / 10 kHz
Stray inductance	ESL		≤ 40	nH	
Insulation resistance between terminals	R_i		$> 40'000$	$\text{M}\Omega$	500 VDC - 1 min
Insulation resistance terminals to case	R_i		$> 3'000$	$\text{M}\Omega$	500 VDC - 1 min
Test voltage between terminals	$U \text{ T1}$		4000	VDC	10 s
Operating temp.			- 25 / + 70 °C		
Estimated MTBF			> 200000	h	400 VAC / 20°C
Dimension	Symbol			Unit	Conditions
Width	B max		20	mm	
Height	H max		30	mm	
Length	L max		32	mm	
Terminals					
Axial tinned wire	d		$\varnothing 1.0 \times 40$	mm	
	M1				
	M0				
	Modification	Date	Visa émetteur		

Condensateurs CH 1400 Yverdon-les-Bains
 Kondensatoren Tel.: ++41 24 445 66 88
 Capacitors Fax: ++41 24 445 66 89

Le lanché
Capacitors
A FISCHER & TAUERSCHE COMPANY

HJJ

29.01.2008

faisab5705.XLS