

#6042

METALLIZED POLYPROPYLENE CAPACITORS

PPM-4 70-15.0 g K

PRELIMINARY

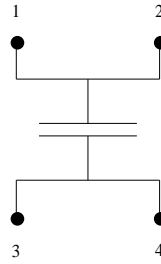
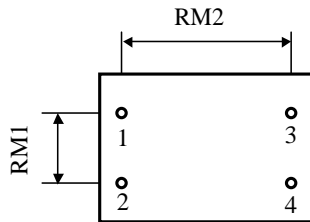

Printed circuit board mounting

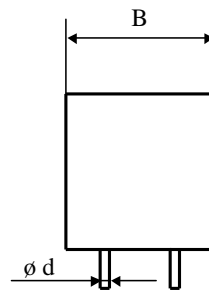
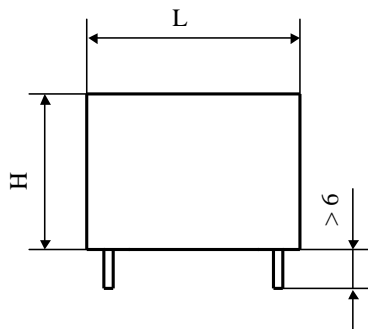

Self-extinguishing plastic housing

Epoxy resin sealing

| Parameter | Symbol | | Value | Unit | Condition |
|----------------------------------|-------------|------|-----------------|--------------------|-------------------|
| Capacitance | C | | 15 | μF | 1 V / 1 kHz |
| Tolerance | | | ± 10 | % | |
| Rated voltage | Un DC | | 700 | VDC | |
| Rated voltage | Un AC | | 400 | VAC | |
| RMS current | I RMS max. | 70°C | 29 | Aeff | 10 kHz to 100 kHz |
| slope of voltage variation | du/dt max. | | 54 | V/ μsec | max. repetitive |
| Repetitive surge current | I cr. max | | 810 | A | |
| Tangent delta | tg δ | | < 5 | E-4 | 1 V / 1 kHz |
| Equivalent serie resistance | ESR | | < 2.5 | m Ω | 100 kHz |
| Stray inductance | ESL | | ≤ 18 | nH | |
| Insulation resistance | Ri | | > 1333 | M Ω | 100 VDC - 1 min |
| Test voltage between terminals | U T1 | | 1'400 | VDC | 10 s |
| Operating temperature | | | - 40 ... + 85°C | °C | |
| Estimated operational life (-3%) | | | > 100'000 | h | Un DC / 70°C |

| Dimension | Symbol | | Value | Unit | Conditions |
|-------------------------------|-----------------|--|----------------|------|------------|
| Width | B max | | 40 | mm | |
| Length | L max | | 58.5 | mm | |
| Height | H max | | 50 | mm | |
| Terminals tinned wire (4 x) | $\varnothing d$ | | 1.2 | mm | |
| RM1 | | | 20.3 \pm 0.4 | mm | |
| RM2 | | | 52.5 \pm 0.4 | mm | |

| | | | | | |
|--|--------------|------|---------------|--|--|
| | M1 | | | | |
| | M0 | | | | |
| | Modification | Date | Visa émetteur | | |

Condensateurs CH 1400 Yverdon, Switzerland
 Kondensatoren Tel.: ++41 24 445 66 88
 Capacitors Fax: ++41 24 445 66 89

Leclanché
Capacitors
A FRANCHI & TALESCHE COMPANY

HJJ

www.Lcap.ch
 06.09.2011

capinfo@Lcap.ch
 faisab6042.XLS