

Leclanché Capacitors  
48, av. de Grandson  
1400 Yverdon, Switzerland

**Leclanché**  
**Capacitors**

A FISCHER & TAUSCHE COMPANY

Tel. +41 24 445 66 88  
Fax +41 24 445 66 89  
[capinfo@LCap.ch](mailto:capinfo@LCap.ch)  
[www.Lcap.ch](http://www.Lcap.ch)

Drawing No. : 1026735-53567

created: hs 17/02/2014 14:35:00

**Typ : GMA47406390235**

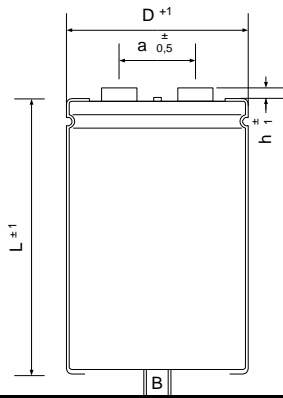

∅ D : 90 mm  
L : 235 mm  
a : 31,7 mm  
h : 5 mm  
B : M12  
Terminals : M6

**Electrical Parameters**

Rated Capacitance ( $C_R$ ) @ 100 Hz / 20 °C	<b>470000</b> $\mu$ F	
Tolerance	<b>±20</b> %	
Rated Voltage ( $U_R$ )	<b>63</b> V	
Surge Voltage ( $U_S$ ) max. 5 x 1 min / h	<b>72</b> V	
Reverse Voltage ( $U_U$ ) max. 1 s	<b>2</b> V	
Leakage Current ( $I_L$ ) @ $U_R$ / 5 min / 20 °C	<b>177</b> mA	
ESR typ. @ 100 Hz / 20°C	<b>1</b> m $\Omega$	
Tan $\delta$ typ. @ 100 Hz / 20°C	<b>27</b> %	
Z max. @ 10 kHz / 20°C	<b>0,8</b> m $\Omega$	
ESL typ.	<b>20</b> nH	
Rated Ripple Current ( $I_R$ ) @ 100 Hz / 85 °C	<b>65</b> A	
Useful life @ $I_R$ , $U_R$ , 85 °C	<b>8000</b> h	
IEC Climatic category / Standards	<b>40/085/56</b>	<b>IEC 60384-4</b>
Applications		
Your article No.. / Project		