

# 3331

Metallized Polypropylene Capacitor

PPMF 230-92.0 cv6

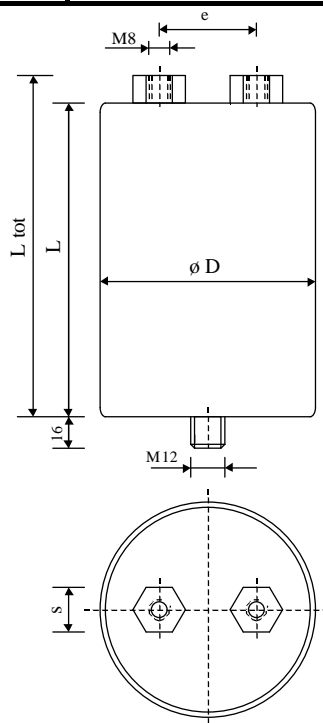

Type PPMF 230-92.0 cv6

Metallized Polypropylene

Aluminium casing  $\phi$  85 x 230 mm, rounded

Bottom Screw M12 x 16

Connections: 2 inserts M8 x 10

Parameters	Symbol	Values	Unit	Condition
Capacitance	C	92	$\mu$ F	
Tolerance		2	%	
Operational Voltage	Uop DC	2200	VDC	
Rated Voltage	Un DC	2300	VDC	
Surge current	Normal	I	A	
	by default	I fault	350	A
Resulting RMS	I rms	5	A	
Charge time	t charge	200	ms	
Maintenance time	t hold	50	ms at Uop	
Discharge time	t disch.	3	ms	
Frequency Cycle	PRF	4	Hz	
Operating		50	$^{\circ}$ C	
Lifecycle		$> 100 \times 10^6$	Discharges at 90% survival	
Serial resistance	ESR	$< 7.5$	m $\Omega$	10 kHz
Equivalent serial	ESL	$< 500$	nH	
Capacitance Test	Ut1	2600	VDC	10 s
Test Voltage against casing		2500	VAC	10 s

Dimension	Symbol	Values	Unit	Condition
Diameter	$\phi D$	85	mm	
Fastening stud	$\phi ds \times Ls$	M12 x 16	mm	
Height	L	232	mm	$\pm 2$ mm
	L tot	239	mm	+ 2 ... - 4 mm
Contact		M8 x 10	mm	
Pitch	e	32	mm	
Overhang		7	mm	0 ... - 2 mm
	s	19	mm	

	M1			
	M0	21.06.02	HJJ	
	Modification	Date	Author	

Condensateurs CH 1400 Yverdon, Switzerland

Kondensatoren Tel.: +41 24 445 66 88

Capacitors Fax: +41 24 445 66 89

HJJ

19.01.00

PPMF3331.XLS