

#6234

## Discharge Capacitors

PPMF 200-175.0 r K

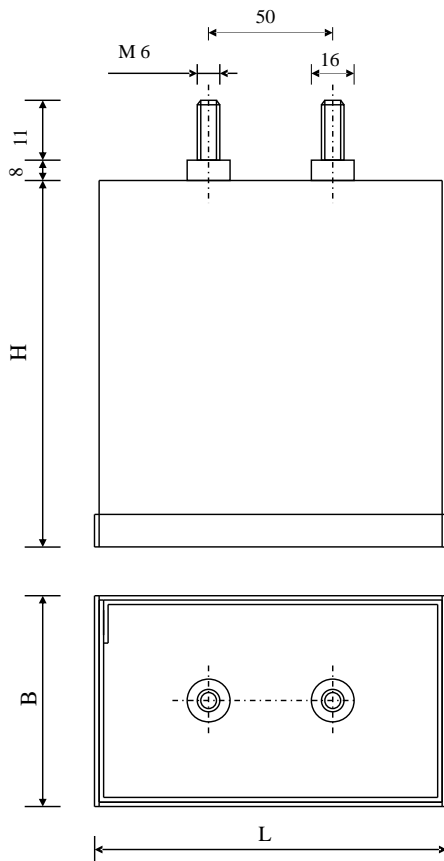

Dielectric of metallized polypropylene

Threaded outputs

Resin end sealing

Aluminium case  
thick 1.2 mm

Parameter	Symbol	Value	Unit	Condition
Capacitance	C	175	$\mu\text{F}$	1 V / 100 Hz
Tolerance		$\pm 10$	%	
Rated Voltage	Un DC	2'000	VDC	
Rated reversal Voltage	U inv.	20	%	
Default reversal Voltage	U inv. S.	80	%	
Discharge Current	I cr. max	5.4	kA	
Default Current	Is.	8.1	kA	
Maximum RMS current	I RMS	53	A	
Tangente delta	tg $\delta$	$\leq 100$	$10^{-4}$	1 V / 100 Hz
Stray inductar	ESL	$\leq 200$	nH	
Insulation resistance	Ri x C	$> 30'000$	s	500 VDC - 1 min
Test voltage between terminals	U T1	4'000	VDC	10 s
Test voltage between terminals to case	U T2	3'500	VAC	50 Hz - 1 min
Estimated operational life		$330 \times 10^6$	Cycles	2.4 kV p-p / 5.4 kA
Estimated operational life		100'000	hours	2 kVDC / 70 °C

Dimension	Symbol	Value	Unit	Conditions
Width		95	mm	
Length		116	mm	
Height		267	mm	
Thread		M6 x 11	mm	
	M1			
	M0			
	Modification	Date	Visa émetteur	

Condensateurs CH 1400 Yverdon, Switzerland  
 Kondensatoren Tel.: ++41 24 445 66 88  
 Capacitors Fax: ++41 24 445 66 89

**Lecan**  
**Capacitors**  
A FISCHER & TAUSSCH COMPANY

HJJ

www.Lcap.ch  
 04.01.2014

capinfo@Lcap.ch  
 faisab6234.XLS