

#5548

Power capacitors

PPM 280-4.0 uv K

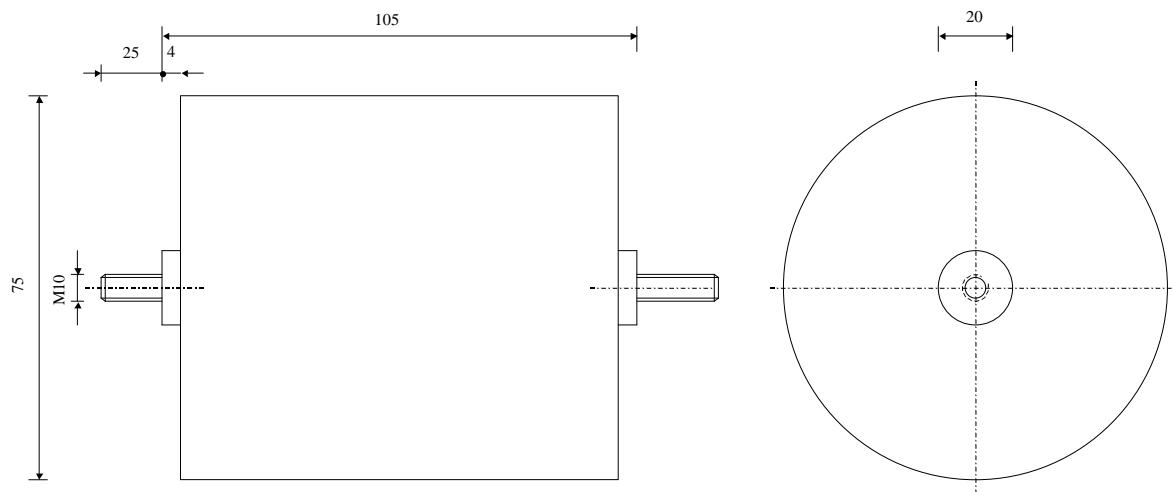

Dielectric of metallized polypropylene - Plastic tube

Polyurethane resin end sealing - Threaded outputs

Parameter	Symbol		Value	Unit	Condition
Capacitance	C		4	μF	1 V / 1 kHz
Tolerance			± 10	%	
Rated voltage	Un DC		2'800	VDC	
Ueff	U RMS		1200	V	RMS
Surge voltage	Us		4'200	V	
RMS Current max	Ieff		48	A	
Repetitive surge current	I cr. max		800	A	
Default current	Is		1800	A	
Tangente delta dielectric	tg δ_o		2	10^{-4}	
Serie resistance	RS		≤ 2.5	m Ω	
Stray inductance	ESL		≤ 15	nH	
Insulation resistance	Ri x C		$> 20'000$	s	500 VDC - 1 min
Test voltage between terminals	U T1		5'000	VDC	60 s
Climatic category (IEC68)			25/70/56		

Dimension	Symbol		Value	Unit	Conditions
Diameter	$\varnothing D$		75	mm	
Heigth	H		105	mm	
Terminals					
Thread			M10 x 25	mm	
	M1				
	M0				
	Modification	Date	Visa émetteur		

Condensateurs CH 1401 Yverdon-les-Bains
 Kondensatoren Tel.: ++41 24 445 66 88
 Capacitors Fax: ++41 24 445 66 89

Le Lanché
Capacitors
A FISCHER & TAUSSIG COMPANY

HJJ

23.03.2006

faisab5548.XLS