

FEATURES

- SUPER LOW ESR AT HIGH FREQUENCY
- WIDE TEMPERATURE RANGE TO + 125°C
- 2,000 HOUR MINIMUM LIFE
- VERY HIGH RIPPLE CURRENT
- SOLVENT RESISTANT

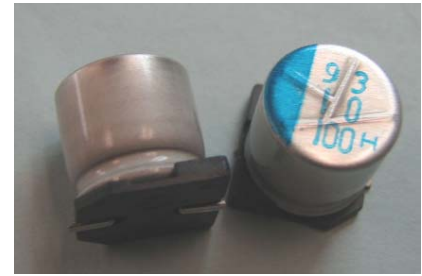

PART NUMBERING

| Part Number Example: MXCPB-016/101M10X10.5TR13F G | | | | | | | | | | |
|---|---|------------------|---|------------------------|----------------|---------|----------------|-----------|----------------|---------|
| MXCPB | - | 016 | / | 101 | M | 10X10.5 | TR | 13 | F | G |
| Type | | Rated DC Voltage | | Capacitance Code (μF)* | Tolerance Code | Size | Package Code** | Reel Size | RoHs Compliant | pb Free |
| * Capacitance Code: First two digits represent significant figure, third digit represents multiplier (number of zeros). | | | | | | | | | | |
| ** Package Code: TR = Tape & Reel. | | | | | | | | | | |

SPECIFICATIONS

| ITEMS | | CHARACTERISTICS | | | |
|---|--|----------------------|--|--------------|----|
| VOLTAGE RANGE | | | 6.3 | 10 | 16 |
| SURGE VOLTAGE | | ROOM TEMPERATURE | 8.2 | 13 | 20 |
| TEMPERATURE RANGE | | | -55 ~ +125°C | | |
| CAPACITANCE RANGE | | | 33~1000μF | | |
| CAPACITANCE TOLERANCE | | @ 120Hz 20°C | M (+20%) | | |
| DISSIPATION FACTOR % | | @ 120Hz 20°C | 18 | 16 | 14 |
| DC LEAKAGE CURRENT | | (μA) AFTER 2 MINUTES | 0.2 CV OR 100, WHICHEVER IS GREATER | | |
| TEMPERATURE CHARACTERISTICS IMPEDANCE RATIO | @ 120Hz & 20°C | -55°C | Z/Z 20°C | 0.75 TO 1.25 | |
| | | 125°C | Z/Z 20°C | 0.75 TO 1.25 | |
| LOAD LIFE | @ 125°C RATED VOLTAGE AND RATED RIPPLE CURRENT | TEST | D 6.3=1500Hrs, D 8>= 2000Hrs | | |
| | | ΔC/C | WITHIN +-30% OF INITIAL MEASURED VALUE | | |
| | | DF | LESS THAN 200% OF SPECIFIED VALUE | | |
| | | ESR | LESS THAN 200% OF SPECIFIED VALUE | | |
| | | LC | LESS THAN SPECIFIED VALUE | | |

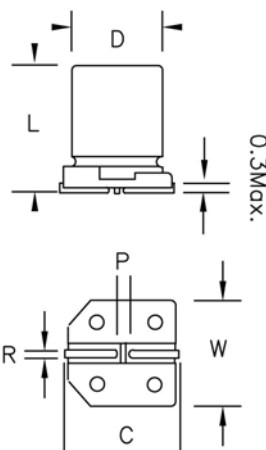

| SIZE D X L | D | L MAX | W +0.2 | C +0.2 | R | P |
|------------|-----|-------|--------|--------|---------|-----|
| 6.3x6 | 6.3 | 6.3 | 6.6 | 7.3 | 0.5~0.8 | 2.2 |
| 6.3x7.7 | | 8 | | | | |
| 8 X10.5 | 8 | 10.8 | 8.3 | 9 | 0.7~1.0 | 3.2 |
| 10 X10.5 | 10 | 10.8 | 10.3 | 11 | 1.0~1.4 | 4.6 |

STANDARD PRODUCT TABLE (dØ X L(mm)), ESR & RIPPLE CURRENT

| (µF) | 6.3VDC | | | 10VDC | | | 16VDC | | |
|------|---------|----|------|---------|----|------|---------|----|------|
| 33 | | | | | | | 6.3x6 | 54 | 640 |
| 47 | | | | 6.3x6 | 40 | 850 | 6.3x7.7 | 45 | 830 |
| 68 | | | | 6.3x6 | 40 | 850 | | | |
| 100 | 6.3x6 | 36 | 920 | 6.3x7.7 | 35 | 1020 | 8X10.5 | 22 | 1300 |
| 150 | 6.3x6 | 36 | 920 | | | | 10X10.5 | 20 | 1650 |
| 220 | 6.3x7.7 | 32 | 1140 | | | | | | |
| 330 | | | | 8X10.5 | 18 | 1580 | | | |
| 560 | 8X10.5 | 16 | 1780 | 10X10.5 | 18 | 2060 | | | |
| 1000 | 10X10.5 | 15 | 2200 | | | | | | |

ESR m Ω @ 100KHz 20°C
RIPPLE CURRENT mA @ 100KHz 125°C