

#6405

METALLIZED POLYPROPYLENE CAPACITORS

PAM 138-022 cv4 K

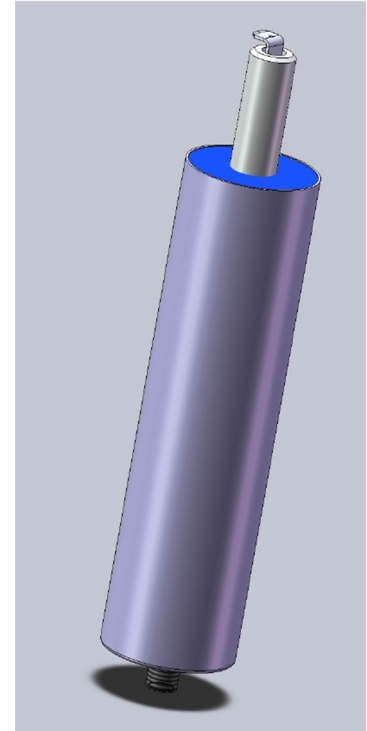
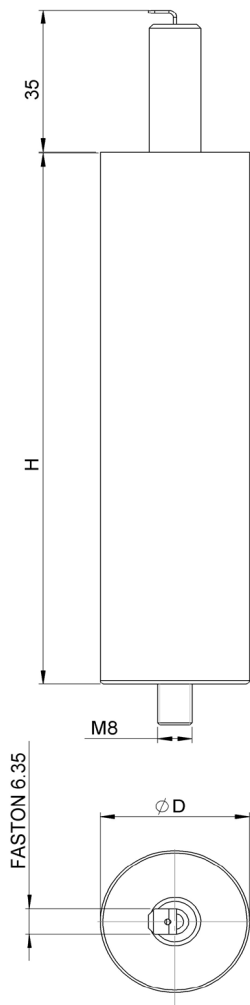

Dielectric of metallized polypropylene

FAST-ON 6.3 x 0.8 mm

Resin end sealing

Aluminium case

Parameter	Symbol	Value	Unit	Condition
Capacitance	C	0.22	μF	1 V / 1 kHz
Tolerance		± 10	%	
RMS voltage	U RMS	1380	V RMS	1700 Hz
Rated voltage	U _r	2000	VAC	
repetitive surge current	I cr. max	150	A	
RMS current	I RMS	5.1	A	10 kHz
Tangent delta	tg δ	≤ 5	10^{-4}	1 V / 1 kHz
Stray inductance	ESL	≤ 100	nH	
insulation resistance between terminals	R _i	$\geq 50\,000$	M Ω	500 V / 1 min
Test voltage between terminals	U T	3500	VAC	50 Hz / 10 sec.
Ambiant temperature		- 20 ... + 80	$^{\circ}\text{C}$	
Dimension	Symbol		Unit	Conditions
Diameter	D	35	mm	
Height	H	131	mm	
Terminals				
Fast-on		6.3 x 0.8	mm	
fixing stud		M8	mm	
	M1			
	M0			
	Modification	Date	Visa émetteur	

Condensateurs CH 1400 Yverdon, Switzerland
 Kondensatoren Tel.: ++41 24 445 66 88
 Capacitors Fax: ++41 24 445 66 89

Lecclanché
Capacitors
A FISCHER & TAUSCHÉ COMPANY

HJJ

www.Lcap.ch
 15.06.2015

capinfo@Lcap.ch
 faisab6405.XLS