

#6100

METALLIZED POLYPROPYLENE CAPACITORS

PPM 250-1.0 cv5 K

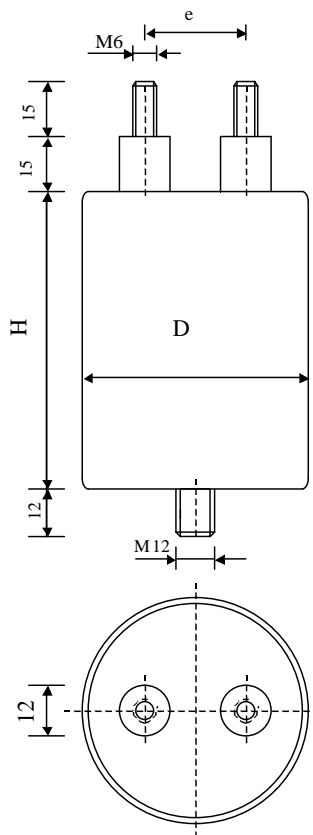

Dielectric of metallized polypropylene

Threaded outputs

Resin end sealing

Aluminium case

Parameter	Symbol	Value	Unit	Condition
Capacitance	C	1	μF	1 V / 1 kHz
Tolerance		± 10	%	
Rated voltage	Un DC	2500	VDC	
Rated voltage	Un AC	850	VDC	50 Hz to 100 Hz
RMS Current permanent	I _{eff max.}	20	A _{eff}	10 kHz to 100 kHz
Repetitive surge current	I _{cr. max}	500	A	
Tangent delta	tg δ	≤ 4	10^{-4}	1 V / 1 kHz
Equivalent serie resistance	ESR	9	m Ω	1 V / 10 kHz
Stray inductance	ESL	≤ 110	nH	
Insulation resistance	R _i x C	$\geq 30'000$	s	500 VDC - 1 min
Test voltage between terminals	U T1	5000	VDC	10 s
Test voltage terminals to case	U T2	5000	VDC	10 s
Operating temp.		- 25 / + 85 °C		
Estimated operational life (-7 %)		> 100'000	h	Un DC / 70°C
Dimension	Symbol	Value	Unit	Conditions
Diameter	D	60	mm	
Height	H max	105	mm	
Terminals				
Thread		M6 x 15	mm	
Thread spacing	e	20 \pm 0.5	mm	
Fixing stud		M12 x 12	mm	
	M1			
	M0			
	Modification	Date	Visa émetteur	

Condensateurs CH 1400 Yverdon, Switzerland
 Kondensatoren Tel.: ++41 24 447 22 82
 Capacitors Fax: ++41 24 447 22 85

Lecdanché
Capacitors
A FISCHER & TESSLER COMPANY

HJJ

www.Lcap.ch
 09.05.2012

capinfo@Lcap.ch
 faisab6100.XLS