

#	Capacitor for power electronics	TYPE KPS 100-1.0
---	---------------------------------	---------------------

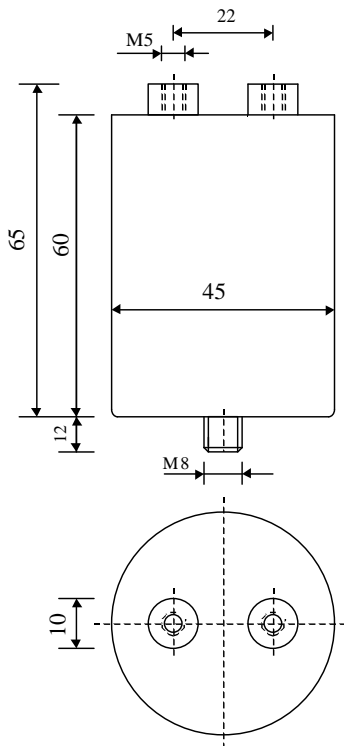

Dielectric  
Metallized polypropylene  
and film/foil

Threaded outputs

Epoxy resin end sealing

Aluminium case

Parameter	Symbol	Value	Unit	Condition
Capacitance	C	1	μF	20°C, 1 kHz
Tolerance		± 10	%	
Rated	Un DC	1000	VDC	
Rated	Un AC	400	VAC	50 Hz
RMS current max	I	20	A	f > 10 kHz
slope of voltage	du/dt N.	400	V/μs	
Power loss	tgδ	< 3.5 E-4		1 V / 1 kHz / 25 °C
Equivalent serie	ESR	≤ 6.4	mΩ	1 V - 10 kHz
Stray	ESL	≤ 40	nH	
Insulation	Ri x C	> 10'000	s	500 VDC - 1 min
Test voltage between	U T1	1800	VDC	10 s.
Climatic		25/70/56		
Estimated operational life (-3%)		100'000	h	Un DC / 70°C

Dimension	Symbol	Value	Unit	Condition
Diameter	∅ D	45	mm	
Height	H	60	mm	
Terminals				
Thread		M5 x 10	mm	
Thread		22	mm	
fixing stud		M8 x 12	mm	

	M2			
	M1			
	M0			
	Modification	Date	Author	