

# 5693	METALLIZED POLYPROPYLENE + FILM-FOIL CAPACITORS	TYPE KPS 85-2.0 df (K)
--------	----------------------------------------------------	---------------------------

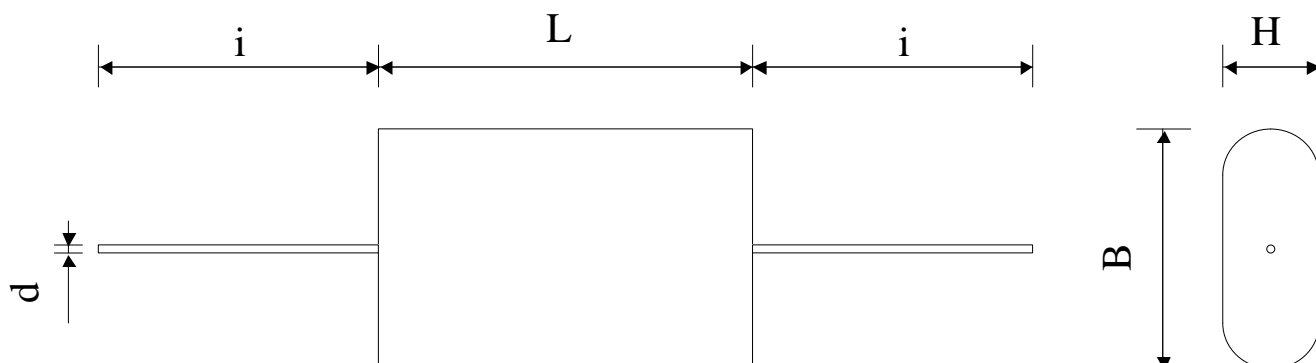

Dielectric: Polypropylene metallized + film-foil

Plastic sleeve / Epoxy resin sealing

Paramètre	Symbol	Value	Unit	Condition
Capacitance	C	2	μF	20°C, 1 kHz
Tolérance		10	%	
Rated voltage	Un DC	850	VDC	85 °C max.
Rated voltage	Un AC	360	VAC	50 / 60 Hz
RMS Current	I _{eff} max.	22.4	A _{eff}	100 kHz / 70 °C
Slope of voltage variation	du/dt max.	580	V/ μs	max. repetitive
Repetitive surge current	I cr. max	1160	A	max. repetitive
Tangent delta dielectric	tg δ_o	2 E-4		
Serial resistance	R _s	3.3	m Ω	
Stray inductance	ESL	≤ 40	nH	
Insulation resistance	R _i	> 50'000	M Ω	100 VDC - 1 min
Test voltage between terminals	U T1	1'700	VDC	60 s.
Operating Range		-55 / + 105 °C		
Estimated operational life (-3 %)		100'000	h	Un / 70°C

Dimension	Symbole	Value	Unité	Conditions
Width	B max	36.2	mm	
Height	H max	24.7	mm	
Length	L max	64	mm	
Terminals				
Axial tinned wire	d	$\varnothing 1.2$	mm	
Length	i	≥ 40	mm	

	M2			
	M1			
	MC			
	Modification	Date	Visa émetteur	